

**PRELIMINARY PLAN - NOT FOR CONSTRUCTION  
THIS SET IS TO BE USED FOR COST ESTIMATING**

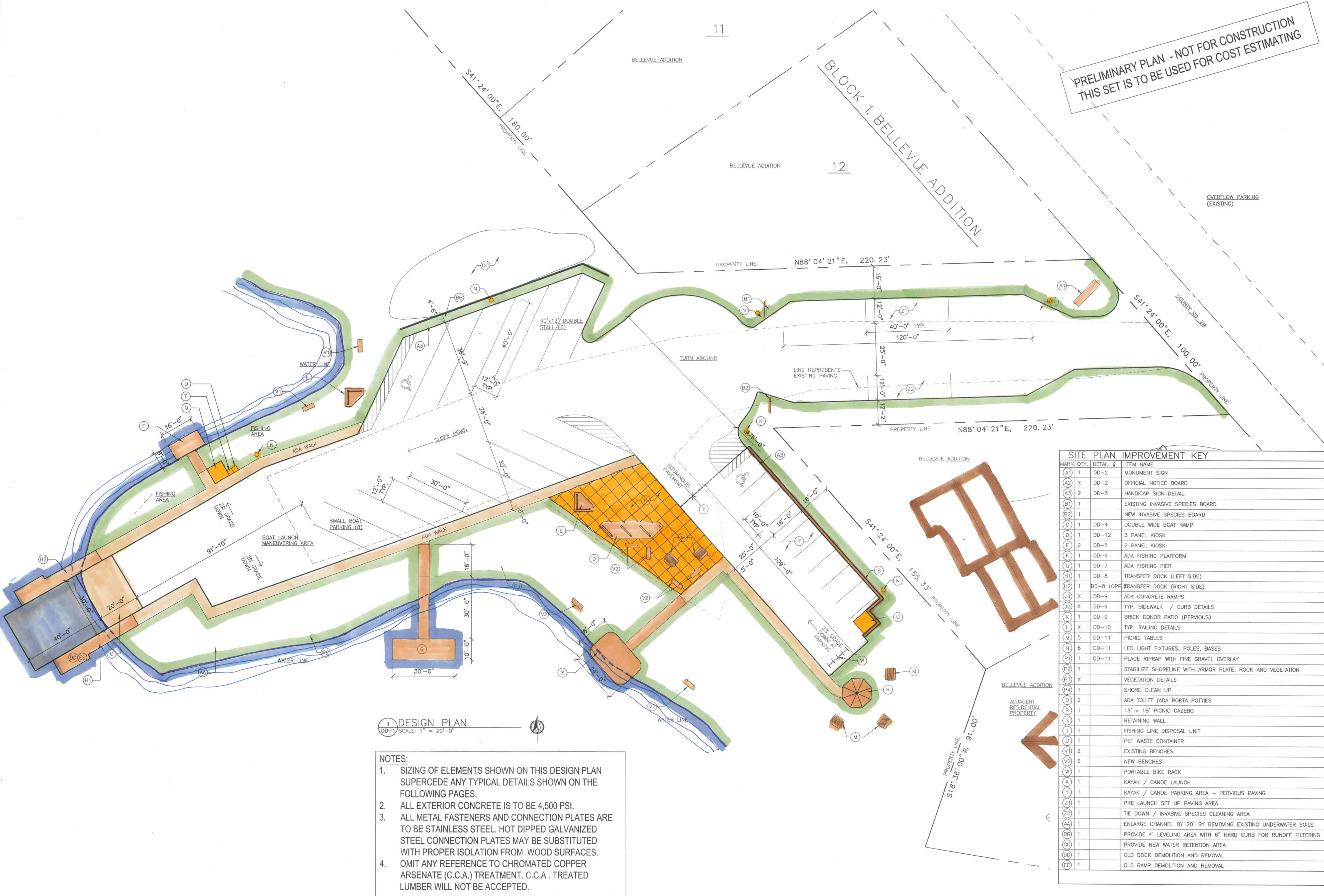

**1 DESIGN PLAN**  
DD-1 SCALE: 1" = 20'-0"

- NOTES:**
1. SIZING OF ELEMENTS SHOWN ON THIS DESIGN PLAN SUPERCEDE ANY TYPICAL DETAILS SHOWN ON THE FOLLOWING PAGES.
  2. ALL EXTERIOR CONCRETE IS TO BE 4,500 PSI.
  3. ALL METAL FASTENERS AND CONNECTION PLATES ARE TO BE STAINLESS STEEL. HOT DIPPED GALVANIZED STEEL CONNECTION PLATES MAY BE SUBSTITUTED WITH PROPER ISOLATION FROM WOOD SURFACES. OMIT ANY REFERENCE TO CHROMATED COPPER ARSENATE (C.C.A.) TREATMENT. C.C.A. TREATED LUMBER WILL NOT BE ACCEPTED.
  - 4.

SITE PLAN		IMPROVEMENT KEY	
MARK	QTY.	DETAIL #	ITEM NAME
(A1)	1	DD-2	MONUMENT SIGN
(A2)	X	DD-2	OFFICIAL NOTICE BOARD
(A3)	2	DD-3	HANDICAP SIGN DETAIL
(B1)	1		EXISTING INVASIVE SPECIES BOARD
(B2)	1		NEW INVASIVE SPECIES BOARD
(C)	1	DD-4	DOUBLE WIDE BOAT RAMP
(D)	1	DD-12	3 PANEL KIOSK
(E)	2	DD-5	2 PANEL KIOSK
(F)	1	DD-6	ADA FISHING PLATFORM
(G)	1	DD-7	ADA FISHING PIER
(H1)	1	DD-8	TRANSFER DOCK (LEFT SIDE)
(H2)	1	DD-8 (OPP)	TRANSFER DOCK (RIGHT SIDE)
(J1)	X	DD-9	ADA CONCRETE RAMPS
(J2)	X	DD-9	TYP. SIDEWALK / CURB DETAILS
(K)	1	DD-9	BRICK DONOR PATIO (PERVIOUS)
(L)	X	DD-10	TYP. RAILING DETAILS
(M)	5	DD-11	PICNIC TABLES
(N)	6	DD-11	LED LIGHT FIXTURES, POLES, BASES
(P1)	1	DD-11	PLACE RIPRAP WITH FINE GRAVEL OVERLAY
(P2)	1		STABILIZE SHORELINE WITH ARMOR PLATE, ROCK AND VEGETATION
(P3)	X		VEGETATION DETAILS
(P4)	1		SHORE CLEAN UP
(Q)	2		ADA TOILET (ADA PORTA POTTIES)
(R)	1		18' x 18' PICNIC GAZEBO
(S)	1		RETAINING WALL
(T)	1		FISHING LINE DISPOSAL UNIT
(U)	1		PET WASTE CONTAINER
(V1)	2		EXISTING BENCHES
(V2)	6		NEW BENCHES
(W)	1		PORTABLE BIKE RACK
(X)	1		KAYAK / CANOE LAUNCH
(Y)	1		KAYAK / CANOE PARKING AREA - PERVIOUS PAVING
(Z1)	1		PRE LAUNCH SET UP PAVING AREA
(Z2)	1		TIE DOWN / INVASIVE SPECIES CLEANING AREA
(AA)	1		ENLARGE CHANNEL BY 20' BY REMOVING EXISTING UNDERWATER SOILS
(BB)	1		PROVIDE 4' LEVELING AREA WITH 6" HARD CURB FOR RUNOFF FILTERING
(CC)	1		PROVIDE NEW WATER RETENTION AREA
(DD)	1		OLD DOCK DEMOLITION AND REMOVAL
(EE)	1		OLD RAMP DEMOLITION AND REMOVAL

I hereby certify that this plan, specification, or report was prepared by me or under my direct supervision and that I am a duly registered architect under the laws of the State of WISCONSIN.  
Number 5517 Date  
This drawing is and will remain the property of the architect and any reproduction or use for any but the specifically agreed upon purposes, without the prior written consent of the architect, is strictly prohibited. Information contained in these drawings was prepared for the specific site listed below. Use of these drawings for any other location or project is strictly prohibited without prior written consent of the architect. ©2014

**MBA**  
MBA Architects, Inc.  
3823 Creekside Lane  
Holmen WI, 54636  
Ph: 608-785-2760  
Fax: 608-785-2750  
E-mail: office@mba-architects.com

FRED FUNK BOAT LANDING  
ONALASKA, WI  
54650

ISSUE DATES:  
09/11/2014

MBA CONTACT  
COLIN H. KLOS  
(608) 785-2760

Drawn by: KJO  
checked by: CHK

THIS SHEET CONTAINS:

**DD1**  
ARCHITECT'S COMMISSION NUMBER  
14-1034.004